



Japan's Fascination with Chinese Painting and Calligraphy, and the National Treasure *Pine Trees in the Snow*

LIST OF EXHIBITS

November 23, 2024- January 19, 2025

 Mitsui Memorial Museum

● National Treasure
◎ Important Cultural Property

ROOM 1

No.	Title	Artist	Period
1-1	Duo Bao Ta Bei	Yan Zhenqing	Tang dynasty, 752
1-2	Xing Fu Si Duan Bei	Wang Xizhi	Tang dynasty, 721
1-3	Shi Ji Si Bei		Tang dynasty, 743
1-4	Bai Dao Sheng Bei	Zhi zong	Tang dynasty, 765
1-5	Yan Ta Sheng Jiao Xu	Chu Suiliang	Tang dynasty, 653
1-6	Letter, addressed to Mitsui Kenzaburō	Mitsui Takatoshi	Meiji period, 19th c.
1-7	Lan Ting Xu	Wang Xizhi	Eastern Jin dynasty, 353, rubbings made in the Song dynasty
1-8	Li Guan Ye Bei	Zheng Yunkui	Tang dynasty, 804, rubbings made in the Song dynasty
1-9	Lan Ting Xu	Wang Xizhi	Eastern Jin dynasty, 353, rubbings made in the Song dynasty
1-10	Ji Wang Sheng Jiao Xu	Wang Xizhi	Tang dynasty, 672, attributed to rubbings made in the Five dynasties
1-11	Li Si Xun Bei	Li Yong	Tang dynasty, around 740, rubbings made in the Song dynasty
1-12	Shi Gu Wen		Warring States period (5-4th centuries BC), rubbings made in the Song dynasty
1-13	Shi Gu Wen		Warring States period (5-4th centuries BC), rubbings made in the Song dynasty

ROOM 2

No.	Title	Artist	Period
2-1	Shi Gu Wen		Warring States period (5-4th centuries BC), rubbings made in the Song dynasty

ROOM 3

3-1	Evening Glow Over a Fishing Village	Shukō	Muromachi period, 15th c.
3-2	Tea bowl, <i>Shukō</i> ceradon, known as " <i>Haran</i> "		Southern Song-Yuan dynasty, 12-14th c.
3-3	<i>Karamono Tsuru-kubi</i> (crane's neck) Tea Caddy		Southern Song dynasty, 12-13th c.

ROOM 4

4-1	Playing civet	Attributed to Emperor Huizong of Song	Ming dynasty, 16-17th c.
4-2	Hérons	Attributed to Zhao Mengfu	Ming dynasty, 16-17th c.
4-3	Crane, Rising Sun and Peach	Attributed to Lu Ji	Ming dynasty, 16-17th c.
4-4	Tiger and Bamboo	Attributed to Yan Hui	16th c.
4-5	Landscape	Attributed to Gao Ranhui	16-17th c.
4-6	Zhuge Liang	Attributed to Xue Chuan	16-17th c.
4-7	Ox and Landscape	Attributed to Zhang Fangru	Muromachi period, 15-16th c.
4-8	● Pine Trees in the Snow	Maruyama Ōkyo	Edo period, 18th c.
4-9	Catalog of paintings and calligraphies owned by Kita-Mitsui family		Edo period, 19th c.
4-10	Apes	Attributed to Muqi	16-17th c.
4-11	Bamboo	Attributed to Su Shi and Lanxi Daolong	16-17th c.
4-12	Cat under the Wisteria	Shen Quan	Qing Dynasty, 18th c.
4-13	Rooster under the Willow	Shen Quan	Qing Dynasty, 1750
4-14	Canna indica and Five Chicks	Shen Quan	Qing Dynasty, 18th c.
4-15	Tiger and Magpies	Shen Quan	Qing Dynasty, 18th c.
4-16	Photo Album of paintings and calligraphies, owned by Kita Mitsui Family		Taishō-Shōwa periods, 20th c.
4-17	Calligraphy	Attributed to Chen Xianzhang	16-17th c.
4-18	Calligraphy	Attributed to Dong Qichang	17-18th c.

ROOM 5

No.	Title	Artist	Period
5-1	<i>Geju</i> (Zen Enlightenment Verse)	Xutang Zhiyu	Southern Song dynasty, 1262
5-2	Postscript of High-priest's Calligraphy Scroll	Yuji Zhihui	Yuan dynasty, 1298
5-3	© Words given to Mumu Issei	Gulin Qingmao	Yuan dynasty, 1327
5-4	Buddhist Teaching given to Yū-zōsu	Zhongfeng Mingben	Yuan dynasty, 14th c.
5-5-1	<i>Geju</i> (Zen Enlightenment Verse)	Liaoan Qingyu	Yuan dynasty, 1349
5-5-2	Letter, addressed to Sano Jōeki, accompanying calligraphy (5-5-1)	Sensō Sōshitsu	Edo period, 17th c.
5-6	Words given to Yu'un-Shishi to bid farewell	Liaoan Qingyu	Yuan dynasty, 1343
5-7	Chinese Poetry	Attributed to Su Shi and Huang Tingjian	16-17th c.
5-8	© The " <i>Takamatsu</i> " Album of Ancient Calligraphy		8-17th c.
5-9	Scenes from the Life of Tao Yuanming	Attributed to Zhao Mengfu	Ming dynasty, 15-17th c.

ROOM 6

6-1	Buddhist Teaching	Lanxi Daolong	Kamakura period, 1271
6-2	Buddhist Teaching	Attributed to Shūhō Myōchō	17-18th c.
6-3	Zen Name with Scriptural Verse	Mingji Chujun	Yuan dynasty, 1329

ROOM 7

7-1	White Plum Blossoms	Attributed to Qian Xuan	Muromachi-Momoyama periods, 15-16th c.
7-2	Sixth Zen Patriarch Tearing up a Sutra	Liang Kai	Southern Song dynasty, 13th c.
7-3	Swallow on a Lotus	Attributed to Muqi	Southern Song dynasty, 13th c.
7-4	Bamboo	Attributed to Su Shi	16-17th c.
7-5	Three pomegranates	Attributed to Muqi	Southern Song dynasty, 13th c.
7-6	Romaine lettuce	Attributed to Muqi	14-16th c.
7-7	Bamboo and Sparrows	Attributed to Muqi	15-16th c.
7-8	Aibika and Butterfly	Attributed to Qian Xuan	Ming dynasty, 16-17th c.
7-9	Cuttlefishes on the lotus	Attributed to Qian Xuan	Ming dynasty, 16-17th c.
7-10	Ginger	Attributed to Zhao Chang	Ming dynasty, 15-17th c.
7-11	Plum blossoms	Attributed to Zhu Quan	16-18th c.
7-12-1	Chinese poetry	Wang Wenzhi	Qing dynasty, 1792
7-12-2	Peony	Attributed to Huang Quan	Ming dynasty, 16-17th c.

Mitsui Memorial Museum

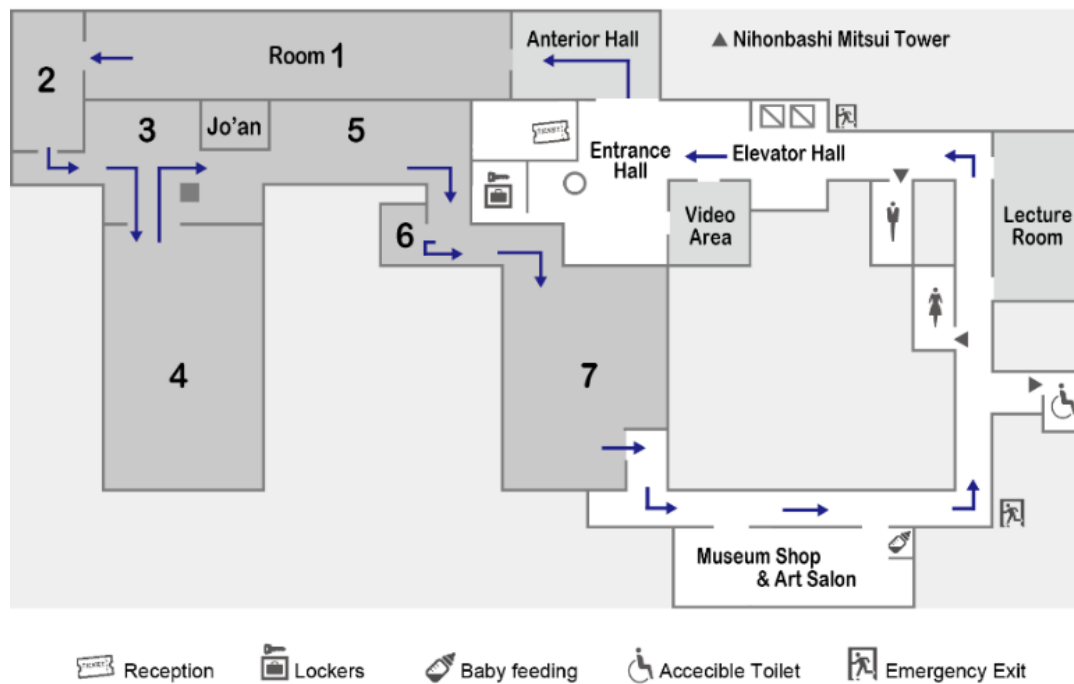

COMING UP NEXT

Special Exhibition:

Enkū's Buddhist Sculptures at Senkōji and in the Hida Region

February 1 (Sat) - March 30 (Sun), 2025



<https://www.mitsui-museum.jp>